



MAGELLAN



MAGELLAN – CHEVROLET / GM

FOR MORE THAN 50 YEARS, WE CONTINUE TO BRING THE BEST BUS DESIGNS

Introducing Magellan, a new model from Collins Bus that has been synonymous with the school bus industry for more than 50 years. After half a century of delivering Type A school buses with A+ marks for strength and safety, Magellan continues on that legacy, from the most trusted bus manufacturer across every segment – Collins Bus.

MAGELLAN FROM COLLINS BUS

Collins Bus developed the first Type A school bus in 1967, and the Magellan continues on that record of excellence ensuring we protect our most important passengers – mile after mile from home to school and back. Innovative engineering leads to a roof structure (roll over test) 5x's stronger than the national standard. With the Magellan design and lean manufacturing process, we will continue to ensure that our school buses are head of the class.



STANDARD CHASSIS EQUIPMENT

Type	Single-Rear Wheel	Dual-Rear Wheel
Wheelbase	139"	139" / 159"
Engine	4.3L V6 (GAS) / 6.6L V8 (GAS)	
Transmission	4.3L engine is 8 speed auto w/HD Overdrive 6.6L engine is 6 speed auto w/HD overdrive	
GVWR	9,900 / 10,100	12,300 / 14,200
Fuel Tank	32 Gallon	
Brakes	4-wheel anti-lock, 4 wheel disc	
Tire	LT245 / 75R16E	
Alternator	220 AMP	
Batteries	Dual 770 CCA	

POPULAR OPTIONS

- 3 points Seats
- 5/8" Marine Grade Flooring (one-piece)
- Activity Seats
- AM/FM/Bluetooth Radio
- Back-up Alarm & Camera
- Battery / Storage Compartment
- Child Restraint Seats
- Colored Rubber Flooring
- Crossing Control Arms
- Electric DOD Door
- Electric Monitors
- Equipment Cage
- Fire Blocking Upholstery
- Interior Mirrors
- Kickout Windows
- LED Lighting Package
- PA System
- Rear Heater
- Rear In-Wall A/C
- Reverse /back-up Sensors
- Roof Escape Hatch
- Window and Seat Level Rubrails (added Strength)
- Safety Equipment
- Spare Tire
- Stainless-Steel Wheel Covers
- Static Roof Vent
- Strobe Lighting
- Track Flooring
- Vandal Lock (Emergency Door)

STANDARD BODY EQUIPMENT

One-piece 1/2" Marine Grade Flooring	3-Point Seats (Required on <10,000 GVWR)
4 Amber / 4 Red Warning Lights	Bench Seats (Required on <10,000 GVWR)
4 Interior LED Dome Lights	Tinted 28"x30" or 36"x30" Split Sash
7" Stop / Tail / Turn Exterior Lights	Windows with 12" Opening
4" Stop / Tail / Turn Exterior Lights	Wrap-Around Rub Rails /Seat & Floor Level
Rearview & Cross view Mirrors	Black-Wrap Around Bumpers
One-Piece Tubular Steel Roof Bows	1.5" Batted Insulation
White Roof	High Density Isolation Pucks

SCHOOL BUS SPECIFICATIONS

	400 - Series		500 - Series
	SRW	DRW	DRW (Only)
Wheelchairs Available *	NO	YES	YES
Maximum Passenger Seating*	20*	28*	34*
Maximum Rows	up to 5	up to 5	up to 6
Elevated Floor (option)	NO	YES	YES
Interior Height (6" from side)	67" (low)	74"	74"
Interior Height (@ Center Aisle)	68" (low) / 76" (high)	77"	77"
Interior Width	78"	91"	91"
Length with Bumpers (Overall)	up to 250"	up to 258"	up to 290"
Width with no Mirrors (Overall)	83"	96"	96"
Manual Entrance Door	25" x 70" / 25" x 78"	25" x 78" / 25" x 82"	25" x 78" / 25" x 82"
Electric Entrance Door	27" x 70" / 27" x 78"	27" x 78" / 27" X 82"	27" X 78" / 27" X 82"

POPULAR FLOOR PLANS

DE516
34 Passengers

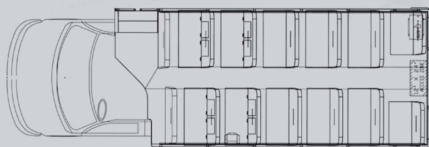

DE516
24 passenger + 1 wheelchair

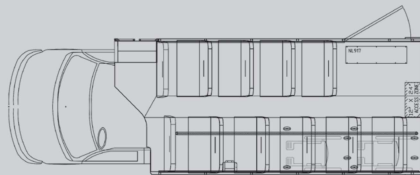

DH400
14 passenger



415 West 6th Street
South Hutchinson, Kansas 67505
www.collinsbus.com